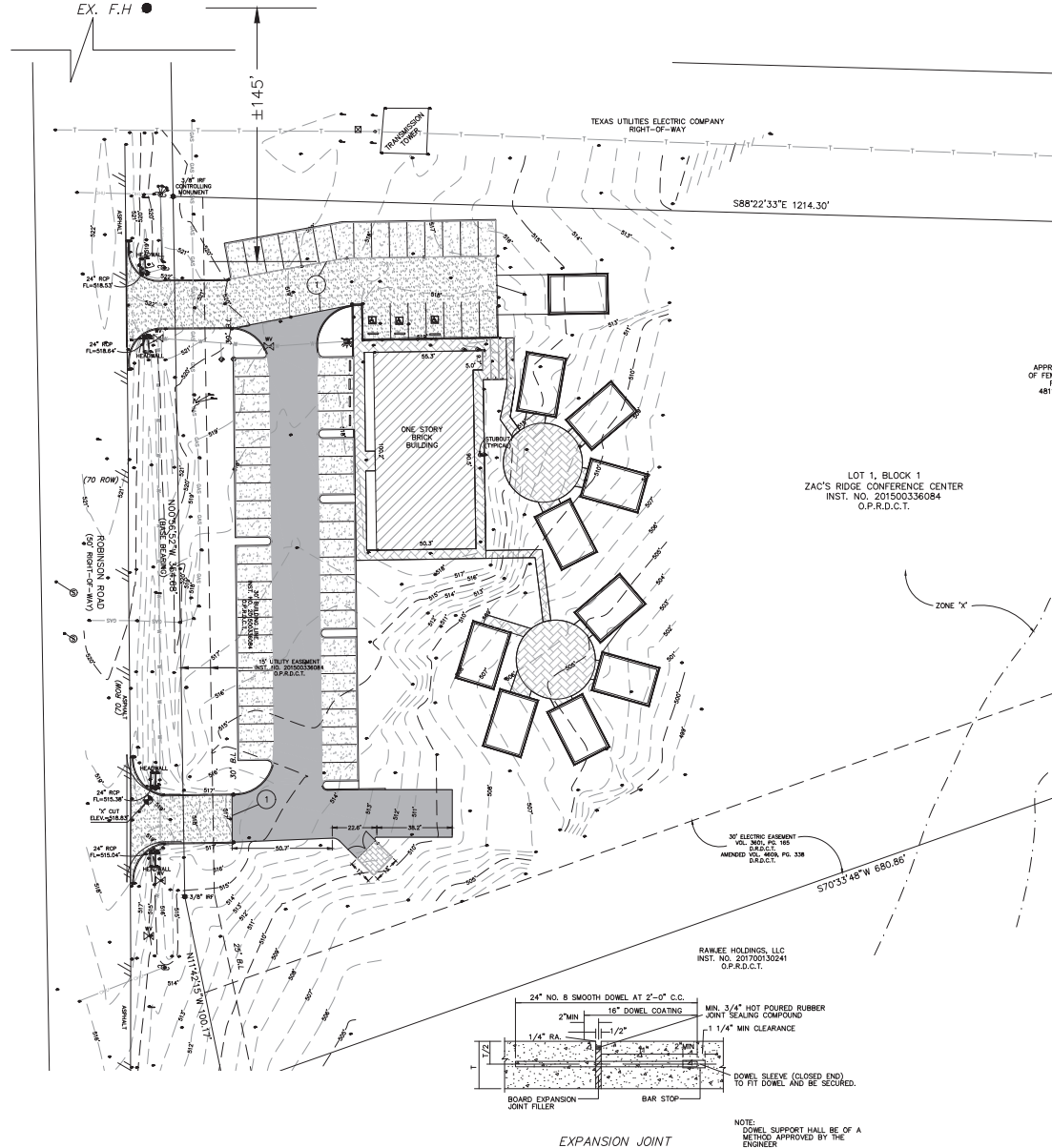

Exhibit B - Amended Site Plan



LEGEND:

- 6" CONCRETE NEW HEAVY DUTY PAVEMENT. #3 REBAR 18" OCEW
- 5" CONCRETE NEW HEAVY DUTY PAVEMENT. #3 REBAR 18" OCEW
- 4" CONCRETE NEW HEAVY DUTY PAVEMENT. #3 REBAR 18" OCEW
- 8" CONCRETE NEW HEAVY DUTY PAVEMENT. #3 REBAR 18" OCEW
- 6" EX. CONCRETE PAVEMENT

REFER TO GEOTECH REPORT, PREPARED BY PARKLAND ENGINEERING, DATED JULY 20, 2015 FOR PAVEMENT AND SUBGRADE PREPARATION

KEY NOTES:

- 1 CONNECT TO EXISTING ASPHALT PAVEMENT WITH #5 DOWEL BARS AT EVERY 12"

ZAC'S RIDGE CONFERENCE CENTER

ZONING: U
 SETBACKS: FRONT 25 SIDE 0 REAR 0
 PARKING: REQUIRED 80 PROVIDED 80
 BUILDING SIZE (SF): 13,400 S.F.
 LOT SIZE (AC): 7.52
 LANDSCAPE AREA (SF): 42,456
 TOTAL IMPERVIOUS (SF): 50,514
 IMPACT ZONE: NORTH

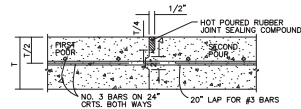

CONSTRUCTION JOINT

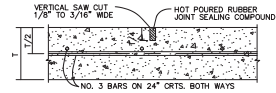

SAWED DUMMY JOINT

NOTE:
 ALL CONSTRUCTION SHALL CONFORM TO THE CITY OF GRAND PRairie PUBLIC WORKS CONSTRUCTION STANDARD AND SPECIFICATIONS. IT IS THE CONTRACTOR'S RESPONSIBILITY TO COMPLY WITH THESE STANDARDS FOR CONSTRUCTION OF THE WATER, SEWER, PAVING, AND DRAINAGE FOR THIS PROJECT.

CITY OF GRAND PRairie C.P.S. MONUMENT
 CITY OF GRAND PRairie C.P.S. MONUMENT NO. 35
 ALUMINUM CAP STAMPED C.P.S. 35 LOCATED 0.44 MILES WEST OF THE INTERSECTION OF MARSHALL DRIVE AND GARBER PARKWAY AT THE N.E. CORNER OF MARSHALL DRIVE AND WEST FREEMAN. 28.5' S.N.E. FROM TRAFFIC SIGNAL BOX AND 36' EAST OF CURB.
 ELEVATION = 576.319
 CITY OF GRAND PRairie C.P.S. MONUMENT NO. 37
 ALUMINUM CAP STAMPED C.P.S. 37 APPROX. 250' SOUTH AND SOUTHWEST OF THE INTERSECTION OF MARSHALL DRIVE AND WEST FREEMAN. 1.4' N.W. OF THE CORNER OF GRAND PRairie AIRPORT AND 29.2' NORTHWEST OF POWER POLE
 ELEVATION = 575.01



0 30 60
 SCALE: 1" = 30'-0"



#	DATE	SUBMISSION
1	6-10-18	BPP
2	11-28-18	DUMPMETER

ZAC'S RIDGE
 CONFERENCE
 CENTER

SITE / DIMENSIONAL
 CONTROL / PAVING
 PLAN

C-2

JOB NO. SHEET