

ARCHITECTURE
INTERIOR DESIGN
GRAPHIC DESIGN

FCA AUTO SALES
3318 E. JEFFERSON STREET
GRAND PRAIRIE, TEXAS 75051

[illegible]

SITE PLAN

| | |
|--------------|------------|
| PROJECT NO.: | 15010 |
| DATE: | 08-17-2015 |
| DRAWN BY: | JHW |
| CHECKED BY: | lhw |

A-001



JEFFERSON SALVAGE
VOL. 2004066 Pg. 11352
D.R.D.C.T.

| | |
|-------------------------------|-----------------------|
| GENERAL DATA | |
| PROPERTY AREA | 0.342 ACRES |
| CURRENT ZONING | LIGHT INDUSTRIAL (LI) |
| REQUIRED PARKING | 4 SPACES |
| PARKING PROVIDED | 16 SPACES |
| REQUIRED LANDSCAPE PERCENTAGE | 4% - 50% ± |

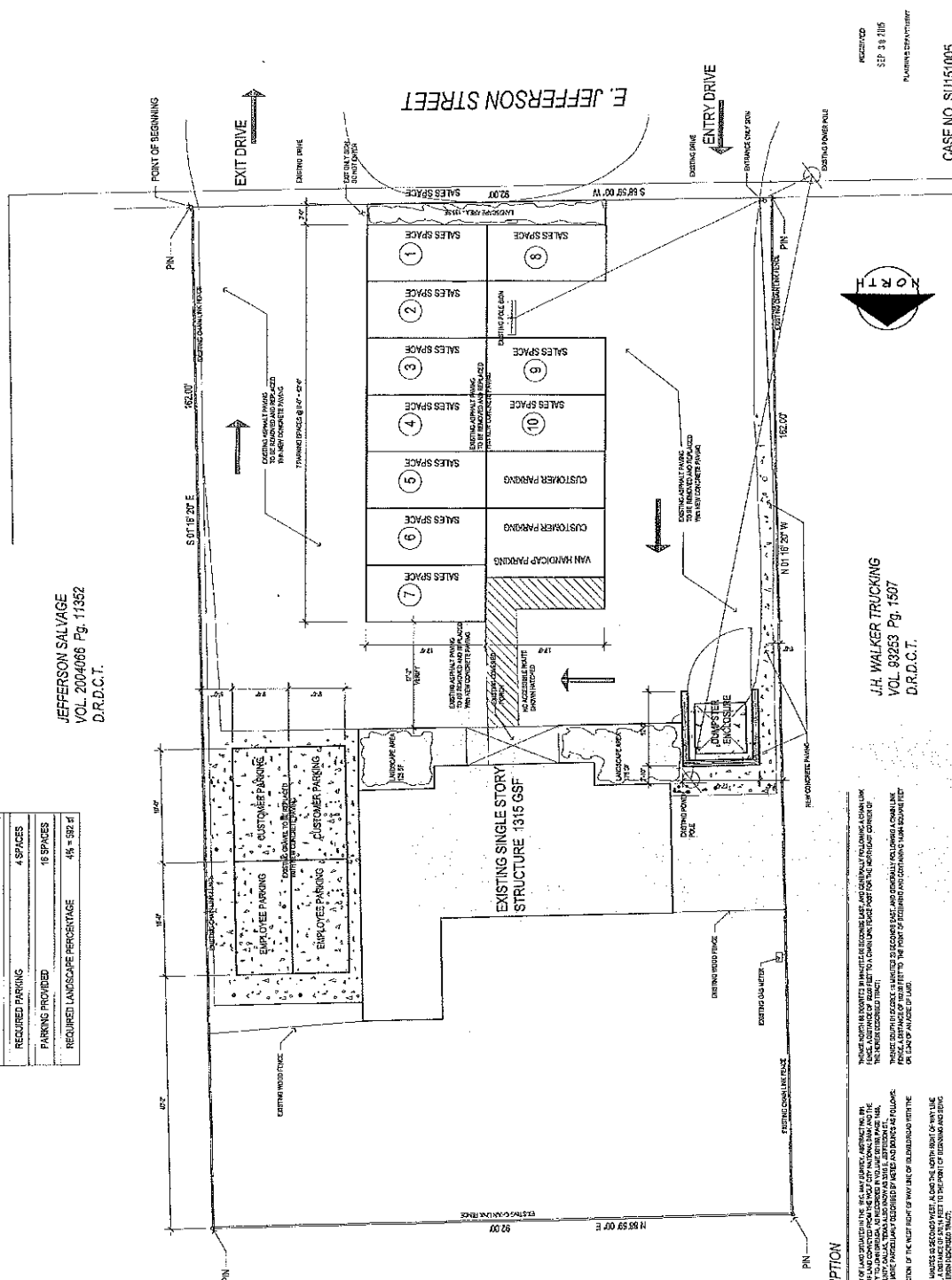

J.H. WALKER TRUCKING
VOL. 93253 Pg. 1507
D.R.C.T.

RECEIVED
SEP 30 2015
FBI LABORATORY

CASE NO. SU151005

1 SITE PLAN

1/30/2000

REGAL DESCRIPTION

[illegible][illegible]