

EXHIBIT "A"
LEGAL DESCRIPTION
PERMANENT WATER LINE EASEMENT

BEING a 30 foot wide strip of land located in the ROBERT R. TUCKER SURVEY, Abstract No. 1473, Grand Prairie, Dallas County, Texas, and being a portion of the tract of land conveyed to the City of Grand Prairie, by the deed recorded in Instrument No. 20080384535, of the Deed Records of Dallas County, Texas. Said 30 foot wide strip of land being more particularly described by metes and bounds as follows:

BEGINNING at a point lying in the South boundary line of aforesaid City of Grand Prairie Tract and the North boundary line of a TESCO right-of-way, recorded in Volume 3599, Page 594, of the Deed Records of Dallas County, Texas, and said POINT OF BEGINNING being located N 04° 49' 38" E 117.91 feet, from a 5/8" iron rod found at the West corner of Lot 17, Block 13, Monterrey Park Phase 2, an addition to the City of Grand Prairie, Dallas County, Texas, according to the plat recorded in Instrument No. 20070201045, of the Official Public Records of Dallas County, Texas;

THENCE S 70° 42' 54" W 35.23 feet, along the South boundary line of said City of Grand Prairie Tract and the North boundary line of said TESCO right-of-way, to a point at the Southwest corner of said City of Grand Prairie Tract;

THENCE N 12° 38' 53" E 188.86 feet, along the West boundary line of said City of Grand Prairie Tract, to a point at the most Westerly Northwest corner of said City of Grand Prairie Tract;

THENCE N 69° 55' 26" E 35.54 feet, along the North boundary line of said City of Grand Prairie Tract, to a point;

THENCE S 12° 38' 53" W 189.44 feet, running along a line 30.0 East of and parallel to the West boundary line of said City of Grand Prairie Tract, to the POINT OF BEGINNING containing 0.130 acre (5,655 square feet) of land.

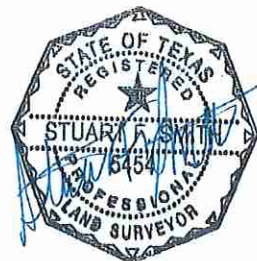

1/10/19

EXHIBIT "B"

BEARING BASE:

THE BEARINGS SHOWN HEREON ARE TEXAS STATE PLANE GRID BEARINGS ESTABLISHED USING THE GLOBAL POSITIONING SYSTEM SATELLITES, AND LOCAL CONTINUOUSLY OPERATING REFERENCE STATIONS.

ROBERT R TUCKER SURVEY
ABSTRACT NO. 1473

HERMAN H AND WILLIE JIMMA
PLATTNER
VOLUME 92245, PAGE 2179
D.R.D.C.T.

CITY OF GRAND PRAIRIE
INST# 20080384535
O.P.R.T.C.T.

PERMANENT WATERLINE
EASEMENT
0.130 ACRE
(5,655 SQ. FT.)

ABELARDO RESENDIZ
INST# 200900143221
D.R.T.C.T.

CITY OF GRAND PRAIRIE
INST# 20080384535
O.P.R.T.C.T.

TESCO ROW
VOLUME 3599, PAGE 594
D.R.D.C.T.

N 04°49'38"E 117.91'
FROM A
5/8" IRON ROD FOUND AT
THE WEST CORNER OF
LOT 17, BLOCK 13,
MONTERREY PARK PHASE 2
INST. NO. 20070201045
O.P.R.D.C.T.

S 70°42'54"W
35.23'

P.O.B.

5/8" IRON
ROD FOUND

LOT 17, BLOCK 13,
MONTERREY PARK
PHASE 2



JANUARY 10, 2019

CITY OF GRAND PRAIRIE, DALLAS COUNTY, TEXAS
ROBINSON ROAD WATERLINE PROJECT



BRITTAIN & CRAWFORD
LAND SURVEYING &
TOPOGRAPHIC MAPPING

TEL (817) 926-0211
FAX (817) 926-0347
P.O. BOX 11374 • 3965 SOUTH FREEDWAY
FORT WORTH, TEXAS 76110
EMAIL: admin@brittain-crawford.com
WEBSITE: www.brittain-crawford.com

FIRM CERTIFICATION# 1019000

PERMANENT WATERLINE
EASEMENT
OF
0.130 ACRE OF LAND
LOCATED IN
THE ROBERT R. TUCKER SURVEY, ABSTRACT
NO. 1473 CITY OF GRAND PRAIRIE, DALLAS
COUNTY, TEXAS

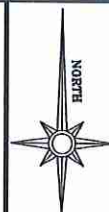

SCALE 1"=30'