

NOTES:

- THE PURPOSE OF THE PROPOSED ZONING CHANGE IS TO REZONE THE PROPERTY FROM AG / RESIDENTIAL TO PD SINGLE FAMILY
- THERE ARE NO AMENITIES PLANNED FOR THIS DEVELOPMENT.

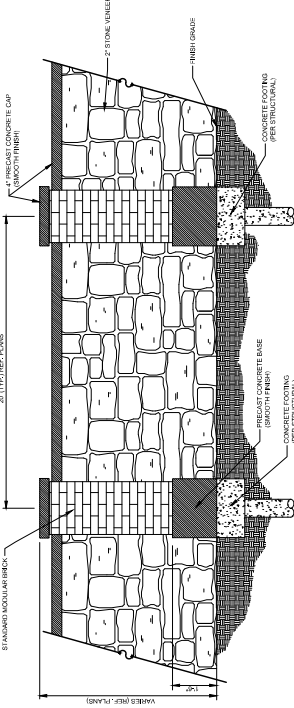
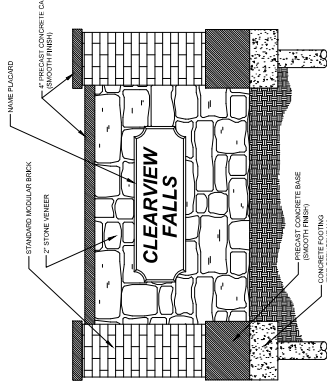
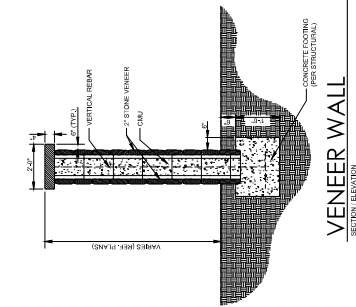
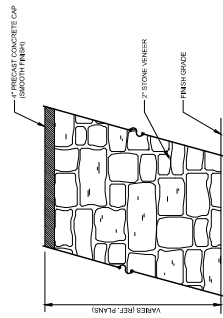

WALL AND COLUMN

ENTRY FEATURE

SCALE: NOT TO SCALE

ELEVATION

SCALE: NOT TO SCALE

ELEVATION (LOCATION SHOWN ON PLANS)

CONCEPTUAL LANDSCAPE AND SCREENING EXHIBIT

CASE NUMBER: Z170702
ACREAGE: 6.63 ACRES TOTAL
PROPERTY DESCRIPTION: 4.46
ACRE TRACT IN CAROLINE M.
ADAMS SURVEY ABSTRACT 38
AND 2.17 ACRES, A PORTION OF
LOT 1 BLOCK 1 OF THE PARIS
ADDITION.
DATE: 06-27-2017

ADDITION,
DATE: 06-27-2011

LEGEND

