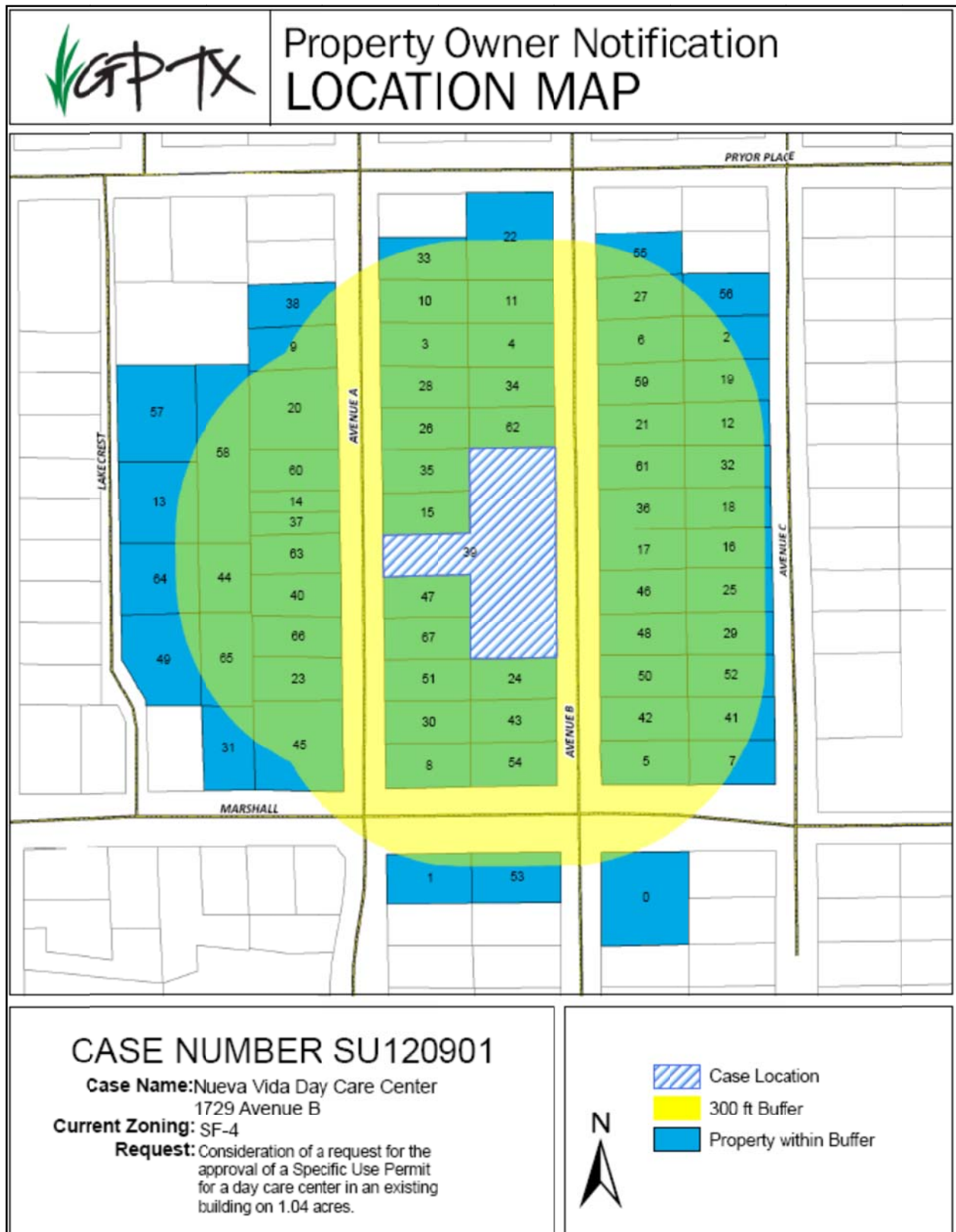

Exhibit 'A'
Location Map
Page 1 of 5



LEGEND

- Proposed Building
- Proposed Parking
- Proposed Driveway
- Proposed Sidewalk
- Proposed Street
- Proposed Utility
- Proposed Tree
- Proposed Plant
- Proposed Structure
- Proposed Fence
- Proposed Wall
- Proposed Gate
- Proposed Sign
- Proposed Light
- Proposed Bench
- Proposed Fire Hydrant
- Proposed Manhole
- Proposed Storm Drain
- Proposed Sewer Line
- Proposed Water Line
- Proposed Gas Line
- Proposed Electric Line
- Proposed Telephone Line
- Proposed Cable Line
- Proposed Fiber Optic Line
- Proposed Irrigation Line
- Proposed Fire Lane
- Proposed Access Road
- Proposed Easement
- Proposed Right of Way
- Proposed Boundary
- Proposed Survey
- Proposed Title
- Proposed Deed
- Proposed Will
- Proposed Trust
- Proposed Partnership
- Proposed Corporation
- Proposed Limited Liability Company
- Proposed Sole Proprietorship
- Proposed Partnership
- Proposed Corporation
- Proposed Limited Liability Company
- Proposed Sole Proprietorship

Site Plan Details:

- Lot Size:** 105,000 sq. ft.
- Building Area:** 9346 sq. ft.
- Available Parking:** 59
- Handicap Parking:** 3
- Existing Trees:**
 - Elm: 4
 - Ash: 1
 - Pine: 4
 - Oak: 1

[illegible]

Exhibit 'A'
Operational Plan
Page 4 of 5

Nueva Vida/New Life Assembly of God
1729 Avenue B
Grand Prairie, TX 75051

Operational Plan
For
Day Care

This facility will be used as a day care center under the name of Nueva Vida Day Care Center. Our hours of operation will be from 6:00am-6:00pm, Monday through Friday. The estimated number of children in our care is 60. These children will range in age from zero years old to 10 years of age. There will be at least four care providers or more in our facility, the number of care providers is dependent on the number of children in our care.

Vida Day Care Center will provide a safe, affordable and high quality preschool environment for the students in our community. Our goal is to prepare children to excel academically when they enter into kindergarten, this will be done through the utilization of scholastic and Mother Goose curriculums.

The building utilized in the operation of our day care center will have liability insurance equal to the minimum requirement of \$1,000,000.00 in coverage.

Food will be available to all children in attendance, all food will be catered, our food serving area will be inspected and be in compliance with all appropriate requirements (City/State). Breakfast will be served at 7:00am. Lunch will begin at 11:00am and an afternoon snack will be served at 2:30pm.

An outside play area measuring approximately 35 feet x 35 feet, is located on the South side of the property. The entrance to the play area is accessible by means of a safe route as defined in Texas Licensing Standards from the back door of our building. The back door will only be used in the event of an emergency as well as for the children to use the outside play area. Everyone else will use the main entrance located in the front of our building.

Exhibit 'A'
Pictures of Existing Building
Page 5 of 5



