

Bank of America

Pioneer and Carrier
817 W Pioneer Pkwy, Grand Prairie TX 75051

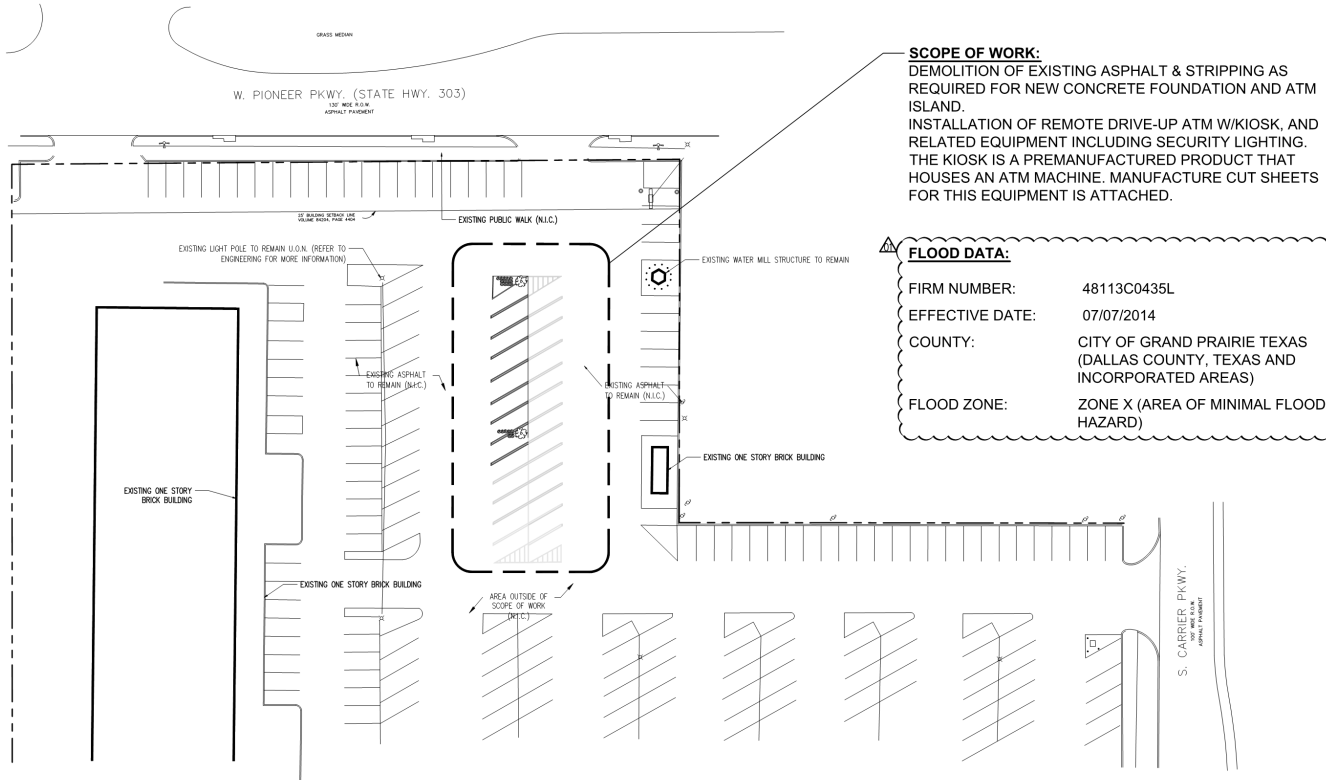

SCOPE OF WORK:
DEMOLITION OF EXISTING ASPHALT & STRIPPING AS REQUIRED FOR NEW CONCRETE FOUNDATION AND ATM ISLAND.
INSTALLATION OF REMOTE DRIVE-UP ATM W/KIOSK, AND RELATED EQUIPMENT INCLUDING SECURITY LIGHTING. THE KIOSK IS A PREMANUFACTURED PRODUCT THAT HOUSES AN ATM MACHINE. MANUFACTURE CUT SHEETS FOR THIS EQUIPMENT IS ATTACHED.

FLOOD DATA:
FIRM NUMBER: 48113C0435L
EFFECTIVE DATE: 07/07/2014
COUNTY: CITY OF GRAND PRAIRIE TEXAS (DALLAS COUNTY, TEXAS AND INCORPORATED AREAS)
FLOOD ZONE: ZONE X (AREA OF MINIMAL FLOOD HAZARD)

PROPOSED SITE PLAN
SCALE: CUSTOM

REVIEW AND APPROVAL

		Approved By: Signature/Date			
Date of Submittal	Phase	JLL PJM	STORE DESIGN	LL/DEVELOPER	GC
	Test-Fit Review	Samuel Gaddis	Michael Mettler		
12-11-2018	Design Development - 50% Review Set	Samuel Gaddis	Michael Mettler		
02-08-2018	CD - 100% Review Set (Arch)	Samuel Gaddis	Michael Mettler		
02-08-2018	Permit Issue Set	Samuel Gaddis	Michael Mettler		
	Construction Issue Set				

THE BANK OF AMERICA PROJECT TEAM ACKNOWLEDGES THESE PROJECT DOCUMENTS ARE APPROVED AS THE FINAL DESIGN AND THAT THE PROJECT DOCUMENTS HAVE BEEN REVIEWED AND APPROVED FOR PERMIT SUBMITTAL AND FOR CONSTRUCTION REGARDLESS OF THE PRESENCE OF SIGNATURE.

PROJECT MANAGEMENT

JONES LANG LaSALLE
7105 Corporate Drive
Plano, TX 75024
PH: (469) 332-5007
Contact: Samuel Gaddis
e-mail: samuel.gaddis@am.jll.com

ARCHITECT

ARCHITECTURAL DESIGN COLLABORATIVE
235 Alcazar Avenue
Coral Gables, FL 33134
PH: (305) 442-1188
Contact: Jonathan Chades
e-mail: jchades@adcinternational.net

M/E/P

P&G ENGINEERING DESIGN GROUP CORP
21 SW 102nd Court
Miami, FL 33174
PH: (786) 863-7091
Contact: Luis O. Perez, PE
e-mail: lperez@pgengineeringdesign.com

CIVIL

H&T CONSULTANTS, INC.
9310 Old Kings Road S. Suite 1001
Jacksonville, FL 32257
PH: (904) 419-1001
Contact: Stanley Hill
e-mail: stanleyhill@bellsouth.net

PROJECT LOCATION

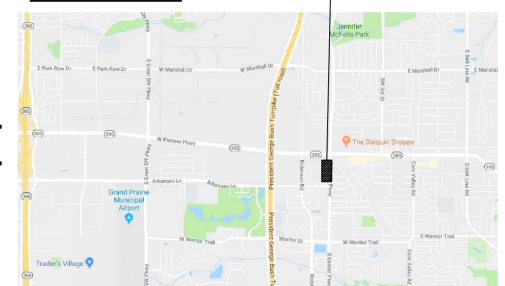

LOCATION MAP
SCALE: N.T.S.

HATCHING LEGEND:
HATCH DENOTES AREA OF EXISTING CONCRETE PARKING SURFACE TO BE REMOVED AND REPLACED WITH NEW CONCRETE. APPROXIMATELY 2500 SQ. FT.

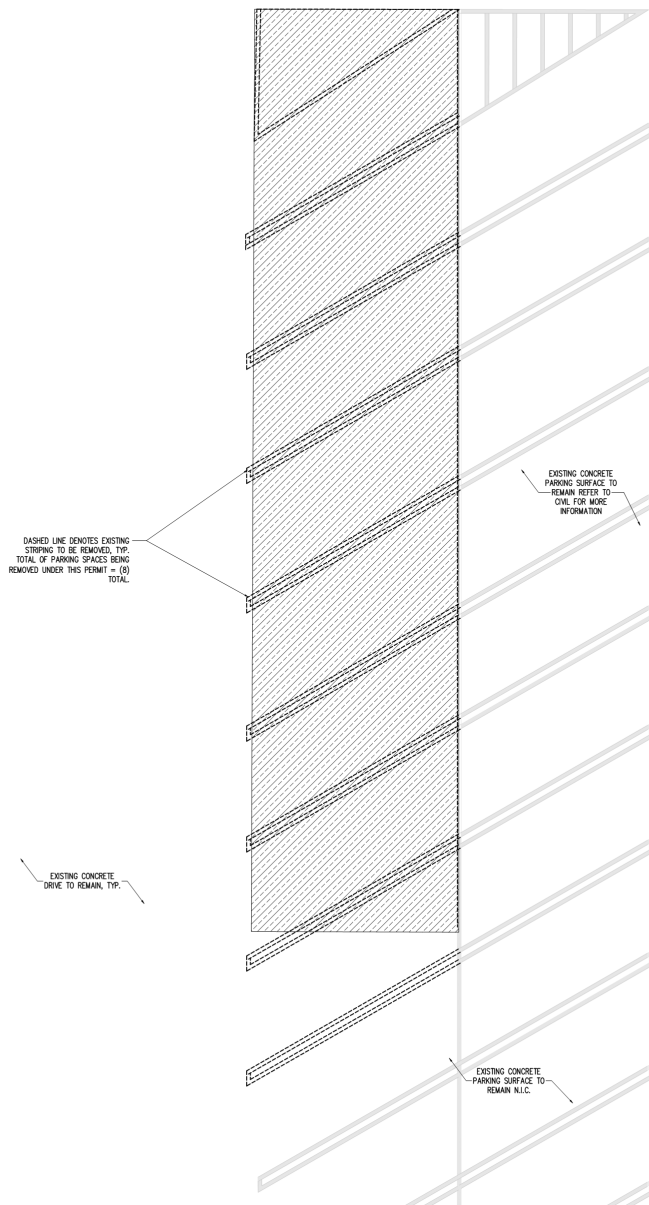

DEMOLITION PLAN
SCALE: 3/16" = 1'-0"

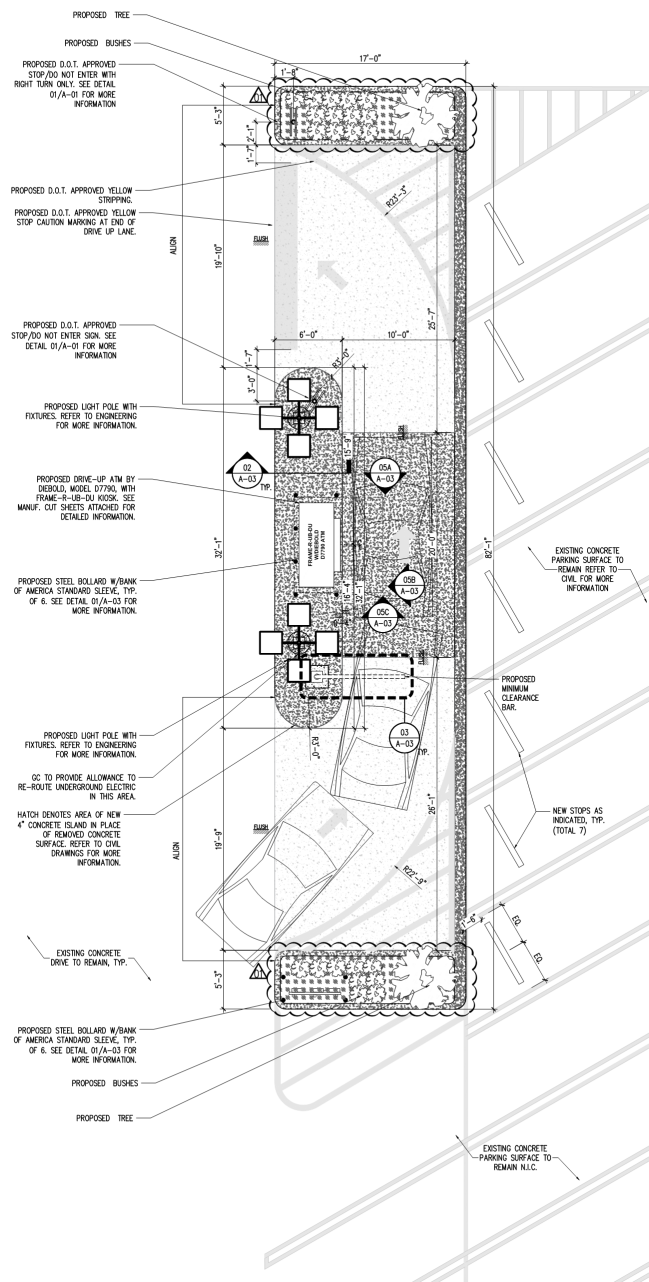

CONSTRUCTION PLAN
SCALE: 3/16" = 1'-0"

ADC
ARCHITECTURAL DESIGN COLLABORATIVE

235 ALCAZAR AVENUE
CORAL GABLES, FL 33134
OFFICE: (305) 442-1188
FAX: (305) 445-1555
WWW.ADCINTERNATIONAL.NET



JONATHAN N. CHADES, R.A.
STATE OF TEXAS REGISTRATION NUMBER 25673
Architect + Seal/Signature

Construction Documents for:
**BANK OF AMERICA
DRIVE-UP ATM INSTALLATION**
Pioneer and Carrier
817 W Pioneer Pkwy,
Grand Prairie TX 75051

Issue	Date & Issue Description	Drawn By	Checked By
01	12-11-2017	ID	JC
	SD REVIEW SET		
02	04-06-2018	ID	JC
	SD PERMIT SET		
03	05-21-2018	ID	JC
	CD PERMIT SET - REVISIONS		

Issue	Date & Issue Description	Drawn By	Checked By
01	05-21-2018	ID	JC
	CD PERMIT SET - REVISIONS		

Client Information
JONES LANG LaSALLE
7105 CORPORATE DRIVE
PLANO, TX 75024
TEL: (469) 333-6007
ATTN: SAMUEL GADDIS
e-mail: samuel.gaddis@jlam.jl.com

Project Number
17133
CAD File Name
17133-Pioneer and Carrier/ATM/Drive-Up-ATM 0004 & RFP Pkwy.dwg
Description
DEMO & PROP PLAN
Scale
AS NOTED
Consultant + Seal/Signature

PERMIT SET



A-02

CASE NUMBER
SU180604/S1180605

01