

NOTES:
 1. The basis of bearing for this survey is the Texas State Plane Coordinate System, based upon GPS measurements, according to the U.S. National Map Accuracy Standards, 2. CM - Database Controlling Monument 2143, NAD 83, as shown on the City of Dallas, Texas, Community Parcel Map 7-1, 2003/175, 2"=1" map. The portion of the subject property lies in a special flood hazard area.
 3. This plat is a preliminary map and does not constitute a building permit. The City of Dallas will not issue a building permit on this plat until the City of Dallas has received all required information and has approved the plat. The plat was approved on the date indicated on the plat.
 4. The plat shows the location of all easements and other interests that affect the subject property. The plat also shows the location of all easements and other interests that affect the subject property.
 5. The plat shows the location of all easements and other interests that affect the subject property. The plat also shows the location of all easements and other interests that affect the subject property.
 6. The plat shows the location of all easements and other interests that affect the subject property. The plat also shows the location of all easements and other interests that affect the subject property.
 7. The plat shows the location of all easements and other interests that affect the subject property. The plat also shows the location of all easements and other interests that affect the subject property.

OWNERS CERTIFICATE
 I, **MOST REVEREND KEVIN J. FARRELL, D.D.**, Bishop of the Roman Catholic Diocese of Dallas and His Successors in Office for the Exclusive Benefit of Immaculate Conception Parish, Grand Prairie, Texas, do hereby certify that the above plat was prepared by **KEETON SURVEYING COMPANY**, a duly licensed and bonded surveying firm in the State of Texas, and the monuments shown thereon were found and/or placed under my personal supervision in accordance with the Commission of the City of Grand Prairie, Texas.
PREPARED BY:
KEETON SURVEYING COMPANY
 H.B. KEETON, Surveyor
 2807 DALWORTH STREET, SUITE 100, GRAND PRAIRIE, TEXAS 75050-2274
 PHONE: (972) 614-8643 FAX: (972) 617-0154

OWNERS
MOST REVEREND KEVIN J. FARRELL, D.D.,
BISHOP OF THE ROMAN CATHOLIC
DIocese OF DALLAS AND
HIS SUCCESSORS IN OFFICE FOR THE EXCLUSIVE
BENEFIT OF IMMACULATE CONCEPTION PARISH, GRAND PRAIRIE
 TEXAS
 2725 WESTGATE DRIVE
 PHOENIX, ARIZONA 85018
 PHONE (602) 326-2240

DEDICATION:
 STATE OF TEXAS, COUNTY OF DALLAS
 NOW, THEREFORE, KNOW ALL MEN BY THESE PRESENTS:
 THAT **MOST REVEREND KEVIN J. FARRELL, D.D., BISHOP OF THE ROMAN CATHOLIC DIocese OF DALLAS AND HIS SUCCESSORS IN OFFICE FOR THE EXCLUSIVE BENEFIT OF IMMACULATE CONCEPTION PARISH, GRAND PRAIRIE, TEXAS**, do hereby dedicate to the City of Grand Prairie, Texas, the **LOT 2R, CHURCH ADDITION**, shown on the above plat as being **LOT 2R, CHURCH ADDITION**, on Grand Prairie in fee simple forever, the streets, alleys and storm water management easements as indicated. The utility, access, GPS monuments and fire hose easements shall be open to the public and private utilities for each particular use. The maintenance of paving on the utility, access and fire hose easements if the improvements or growths, except fences, vegetation, driveways, and sidewalks less than 6 feet in width shall be constructed or placed upon, over or across the easements as shown on the above plat. The plat also shows the location of all easements and other interests that affect the subject property. The plat also shows the location of all easements and other interests that affect the subject property.
 The purpose of this plat is to create a record of the location of all easements and other interests that affect the subject property. The plat also shows the location of all easements and other interests that affect the subject property.
 The plat also shows the location of all easements and other interests that affect the subject property. The plat also shows the location of all easements and other interests that affect the subject property.
 The plat also shows the location of all easements and other interests that affect the subject property. The plat also shows the location of all easements and other interests that affect the subject property.
 The plat also shows the location of all easements and other interests that affect the subject property. The plat also shows the location of all easements and other interests that affect the subject property.

ACKNOWLEDGMENT:
 STATE OF TEXAS, COUNTY OF DALLAS
 Before me the undersigned authority, a Notary Public, on this day personally appeared **M. L. Mitchell**, known to me to be the person whose name is subscribed to the foregoing instrument and acknowledged to me that he executed the same for the purposes and consideration therein expressed and in the capacity therein stated.
 Given under my hand and seal of office on the _____ day of _____, 2016.
 NOTARY PUBLIC
 My Commission Expires: _____

OWNERS CERTIFICATE
 I, **MOST REVEREND KEVIN J. FARRELL, D.D.**, Bishop of the Roman Catholic Diocese of Dallas and His Successors in Office for the Exclusive Benefit of Immaculate Conception Parish, Grand Prairie, Texas, do hereby certify that the above plat was prepared by **KEETON SURVEYING COMPANY**, a duly licensed and bonded surveying firm in the State of Texas, and the monuments shown thereon were found and/or placed under my personal supervision in accordance with the Commission of the City of Grand Prairie, Texas.
PREPARED BY:
KEETON SURVEYING COMPANY
 H.B. KEETON, Surveyor
 2807 DALWORTH STREET, SUITE 100, GRAND PRAIRIE, TEXAS 75050-2274
 PHONE: (972) 614-8643 FAX: (972) 617-0154

ACKNOWLEDGMENT:
 STATE OF TEXAS, COUNTY OF DALLAS
 Before me the undersigned authority, a Notary Public, on this day personally appeared **M. L. Mitchell**, known to me to be the person whose name is subscribed to the foregoing instrument and acknowledged to me that he executed the same for the purposes and consideration therein expressed and in the capacity therein stated.
 Given under my hand and seal of office on the _____ day of _____, 2016.
 NOTARY PUBLIC
 My Commission Expires: _____

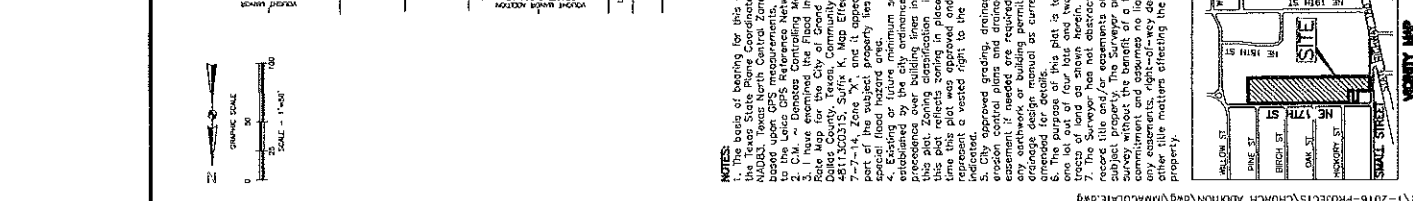

FINAL PLAT
LOT 2R
CHURCH ADDITION
 CONTAINING 0.9172 ACRES
 AN ADDITION TO
 THE CITY OF GRAND PRAIRIE,
 DALLAS COUNTY, TEXAS,
 BEING A REPLAT OF
 LOTS 2, 4, 5, AND 6,
 CHURCH ADDITION
 AND 8.514 ACRES OF LAND IN
 RICHARD WILSON SURVEY, ABSTRACT NO. 1548
 CITY OF GRAND PRAIRIE,
 DALLAS COUNTY, TEXAS
 DATE: NOVEMBER 28, 2016
 REVISED: NOVEMBER 21, 2016
 ONE LOT
 CASE NO. 181730101

ACKNOWLEDGMENT:
 STATE OF TEXAS, COUNTY OF DALLAS
 Before me the undersigned authority, a Notary Public, on this day personally appeared **M. L. Mitchell**, known to me to be the person whose name is subscribed to the foregoing instrument and acknowledged to me that he executed the same for the purposes and consideration therein expressed and in the capacity therein stated.
 Given under my hand and seal of office on the _____ day of _____, 2016.
 NOTARY PUBLIC
 My Commission Expires: _____

OWNERS CERTIFICATE
 I, **MOST REVEREND KEVIN J. FARRELL, D.D.**, Bishop of the Roman Catholic Diocese of Dallas and His Successors in Office for the Exclusive Benefit of Immaculate Conception Parish, Grand Prairie, Texas, do hereby certify that the above plat was prepared by **KEETON SURVEYING COMPANY**, a duly licensed and bonded surveying firm in the State of Texas, and the monuments shown thereon were found and/or placed under my personal supervision in accordance with the Commission of the City of Grand Prairie, Texas.
PREPARED BY:
KEETON SURVEYING COMPANY
 H.B. KEETON, Surveyor
 2807 DALWORTH STREET, SUITE 100, GRAND PRAIRIE, TEXAS 75050-2274
 PHONE: (972) 614-8643 FAX: (972) 617-0154